

X1

General Notes
 Use figured dimensions only. Do not scale off this drawing. All dimensions must be set out and checked by the contractor on site prior to commencement of construction. Any variations between drawings and site must be reported to TGA before work proceeds.
 Drawings to be read in conjunction with Architectural Specification, Structural Engineer's Drawings and Specifications, Mechanical & Electrical Engineer's Drawings and Specifications, all Supplemental Information, including but not limited to: Detailed Fire Strategy, Acoustic Report, Thermal Report & Overheating Report.
 No portion of the Works to commence without acceptance of the required submittals by the Employer.
 Main Contractor to submit relevant documents to building regulation and legislation approval authorities as required to comply with the Specification.

Legend and Notes

01.01 Type ST-01 00	Level, Room Number Student Studio Type or Room Name Area (m2)
[Light Blue Box]	Studio Wheelchair Accessible (Acc)
[Medium Blue Box]	Studio Amenity Back of House Dry
[Dark Blue Box]	Riser Inlet Smoke Shaft Mechanical
[Light Grey Box]	Riser Electrical Riser Life Safety
[Dark Grey Box]	Electrical Riser Firefighting Lift Dry
[White Box]	Riser Stair Davit Arm
[White Box]	Smoke
[White Box]	MR
[White Box]	ER
[White Box]	LSR
[White Box]	FF
[White Box]	DR
[White Box]	[Symbol]

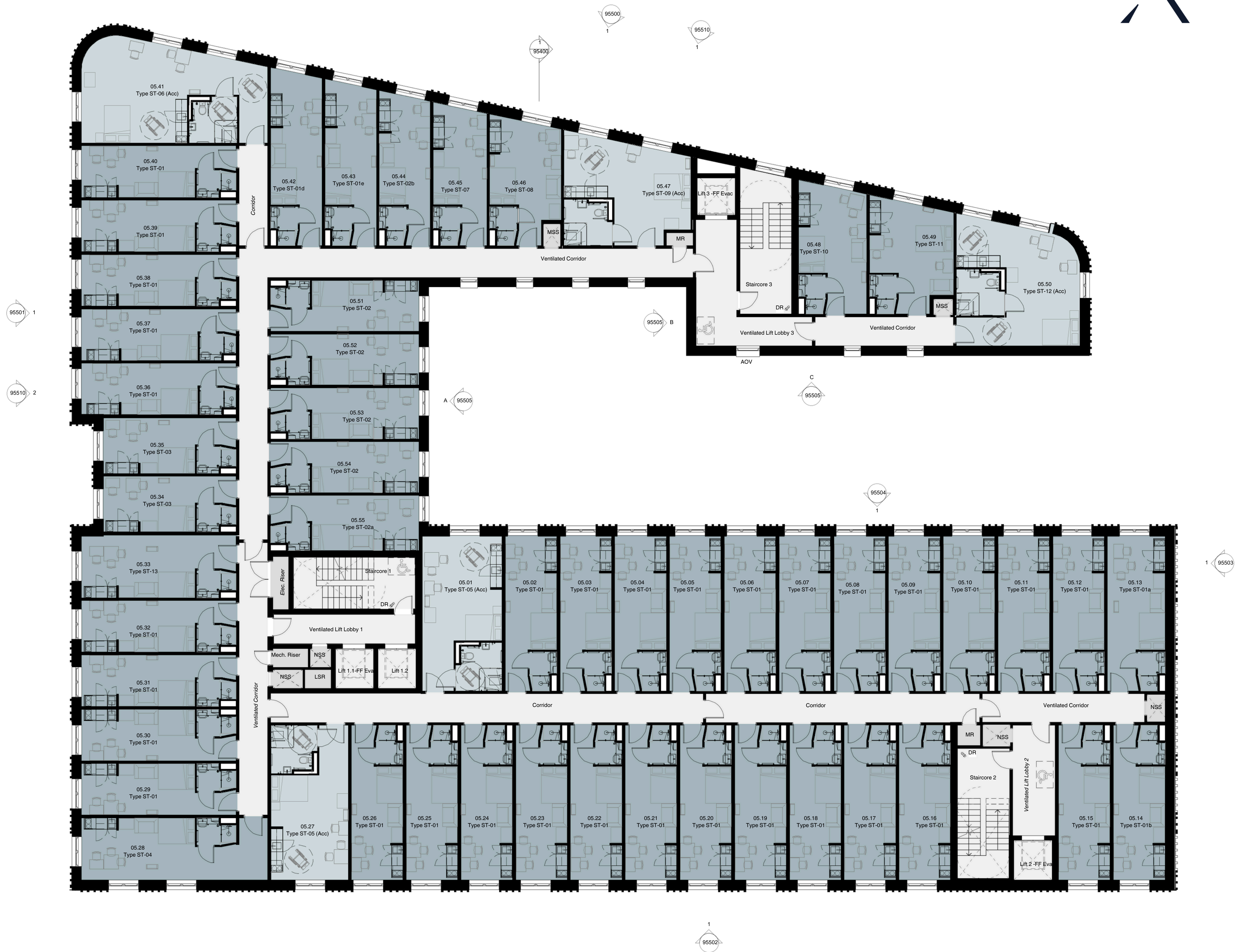

Rev	Description	Date	By
P01	Planning - Preliminary issue to design team	11.12.24	SC
P02	Planning - Revised massing, site boundary and layout	16.05.25	CF

Title
 General Arrangement -Level 05

Drawing No.
 1210-TGA-XX-05-DR-A-95305

Revision
 P02

Status
 Planning

Scale
 1 : 100@A1

Project
 Lissadel Street

Client
 Bridgestone Construction

TIM GROOM ARCHITECTS

Eastgate, 2 Castle Street, Manchester, M3 4LZ

0161 870 1152

Copyright © Tim Groom Architects Ltd (TGA). All rights reserved.
 No part of these drawings or designs may be copied, reproduced or stored in any form without written consent. No works of construction relying on these drawings or designs are permitted without the express written consent of TGA.

